

Load Cell Central

1-800-LOADCEL

Stainless Steel Single Point Load Cell

Model: GCB3-SS & GCB3-SS-M

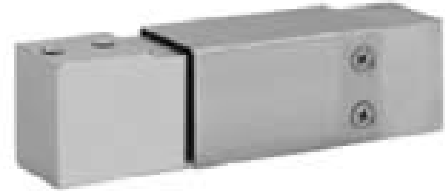

The GCB3-SS low cost, low profile off center load cell is designed for harsh environments. It is manufactured from stainless steel and sealed to IP67. This load cell is ideal for wash down areas such as are found in the food, pharmaceutical, and chemical industries.

Recommended max. platform size: 400mm X 400mm (16"x16").

Model: GCB3-SS

(Imperial Threads)

Capacity:	Model#
5 KG	GCB3-SS-5
8 KG	GCB3-SS-8
10 KG	GCB3-SS-10
15 KG	GCB3-SS-15
20 KG	GCB3-SS-20
30 KG	GCB3-SS-30
50 KG	GCB3-SS-50
75 KG	GCB3-SS-75
100 KG	GCB3-SS-100
150 KG	GCB3-SS-150
200 KG	GCB3-SS-200

Dimensions in mm (inches)

Model: GCB3-SS

Thread M 1/4-20-UNC-2B

Thread N 1/4-28-UNF-2B

Model: GCB3-SS-M

Thread M&N M6-6H

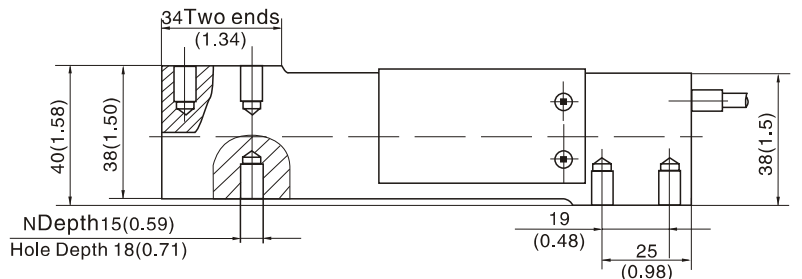

Model: GCB3-SS-M

(Metric Threads)

Capacity:	Model#
5 KG	GCB3-SS-M-5
8 KG	GCB3-SS-M-8
10 KG	GCB3-SS-M-10
15 KG	GCB3-SS-M-15
20 KG	GCB3-SS-M-20
30 KG	GCB3-SS-M-30
50 KG	GCB3-SS-M-50
75 KG	GCB3-SS-M-75
100 KG	GCB3-SS-M-100
150 KG	GCB3-SS-M-150
200 KG	GCB3-SS-M-200

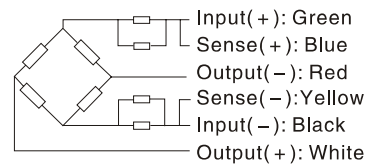
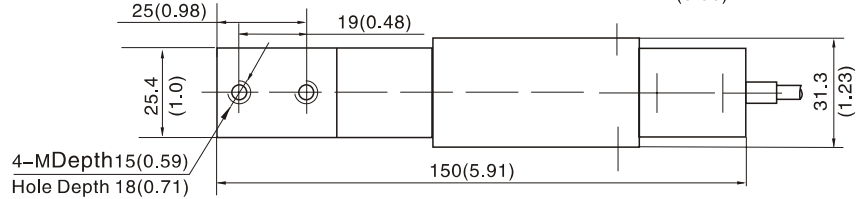

Combined Error:	0.02% FS	Zero Balance:	1.0% FS
Rated Output:	2.0 +/- 0.2 mV/V	Temp. Effect on Output:	0.011% FS/10°C
Non-Linearity:	0.017% FS	Temp. Effect on Zero:	0.019% FS/10°C
Hysteresis:	0.02% FS	Compensated Temp.:	-10 to 40°C
Non-Repeatability:	0.01% FS	Operating Temp.:	-35 to 65°C
Creep (%FS/30min.)	0.016	Recommended Excitation:	10Vdc
Input Resistance:	383 +/- 4 Ohms	Safe Overload:	120% FS
Output Resistance:	351 +/- 2 Ohms	Ultimate Overload:	150% FS
Insulation Resistance Megohm:	≥5,000 (50Vdc)	Cable Length:	3.3' (1 meter)

Load Cell Central follows a policy of continuous improvement and reserves the right to change specifications without notice. © 2009

Load Cell Central
216 Main St. / PO Box 91
Monroeton, PA 18832
Web: www.800loadcel.com

Toll Free: 1-800-562-3235
Ph: 1-570-265-5015
Fax: 1-570-265-5148
Email: sales@800loadcel.com