

Load Cell Central

1-800-LOADCEL

Model: SRP



Precision Pancake
Tension / Compression
Load Cell

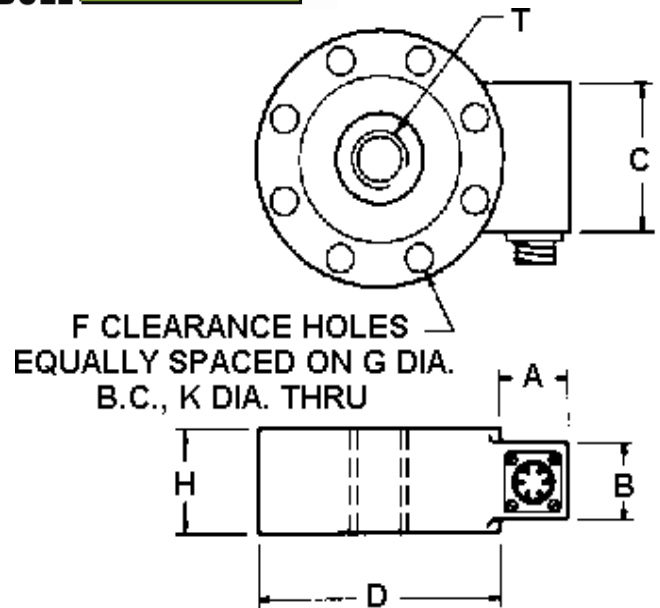

Ranges	D"	H"	F#	G" Dia. B.C.	K" Dia. B.C.	T	A"	B"	C"
5, 10, 25 lbs	2.50	0.80	6	2.00	0.18	1/4-28UNF	0.82	0.75	1.25
50, 100, 250, 500, 1000 lbs	3.00	1.00	6	2.25	0.28	3/8-24UNF	0.82	0.75	1.25
2000, 3000, 4000, 5000 lbs	3.50	1.00	6	2.63	0.34	1/2-20UNF	0.82	0.75	1.25
7500, 10,000, 15,000 lbs	5.50	1.80	8	4.50	0.40	1-14UNS	1.25	1.50	2.00
20,000, 30,000, 50,000 lbs	6.00	1.80	8	4.88	0.53	1-1/2-12UN	1.25	1.50	2.00
75,000, 100,000 lbs	9.00	2.50	12	7.75	0.66	2-12UN	1.25	1.50	2.00
150,000, 200,000 lbs	11.00	3.00	12	9.50	0.78	2-1/2-12UN	1.25	1.50	2.00
300,000, 400,000, 500,000 lbs	14.00	4.25	12	11.75	1.03	3-1/2-12UN	1.25	1.50	**

** check with factory

Bolt holes (K) are counter-bored for ranges 15K and below.

Standard Capacities : 5, 10, 25, **50, 100**, 250, **500, 1K, 2K**, 3K, 4K, **5K**, 7.5K, **10K**,
15K, **20K**, 30K, **50K**, 75K, 100K, 150K, 200K, 300K, 400K, 500K lbs.

BOLD Ranges are in stock for fast delivery.

Output : 3mV/V (2mV/V 5 to 25lb)	Bridge Resistance : 350Ω
Non-Linearity : ±0.1% (±0.2% 5 to 25lb)	Insulation Resistance : > 5000 MΩ
Hysteresis : ±0.08% (±0.1% 5 to 25lb)	Recommended Excitation : 10V
Non-Repeatability : ±0.03% (±0.1% 5 to 50lb)	Maximum Excitation : 15V
Thermal Sensitivity Shift : 0.002% Rdg/°F	Deflection - Full Scale : 0.003"
Thermal Zero Shift : 0.002% FS/°F	Safe Overload : 150%
Comp.Temp. Range* : +60°F to +160°F	Material 5lb to 200K : 17-4PH Stainless
Operating Temp. Range : -65°F to +250°F	Material 300K+ : 4340 Painted
	Output Options : 0-5VDC, 4-20ma.

* custom ranges available

Load Cell Central
216 Main St. / PO Box 91
Monroeton, PA 18832
Web: www.800loadcel.com

Toll Free: 1-800-562-3235
Ph: 1-570-265-5015
Fax: 1-570-265-5148
Email: sales@800loadcel.com