

# Load Cell Central

1-800-LOADCEL

## Model XLS9 / XLS9-S1 Series

S- Beam Load Cell (20Kg ~5t)

The XLS9 S-beam load cell is designed for industrial scale conversion and a variety of process applications.

- Alloy tool steel construction for high accuracy.
- Electroless nickel plated for corrosion resistance.
- Fully sealed to IP67

### SPECIFICATIONS

MODEL	XLS9 / XLS9-S1
Rated capacity (R.C.)	20, 50, 100, 200, 500Kg
	1, 2, 3, 5t 50, 100, 200, 400, 1000 lbs
	2, 4, 6, 10 Klbs
Rated output(R.O.)	3mV/V ± 0.5%
Non-linearity	≤ 0.03% R.O.
Hysteresis	≤ 0.03% R.O.
Non-repeatability	≤ 0.02% R.O.
Creep error	≤ 0.03% in 20min.
Zero balance	≤ 1% R.O.
Compensated temperature range	-10 ~ 70°C
Operating temperature range	-20 ~ 80°C
Temp. effect on rated output	≤ 0.1% LOAD/10 °C
Temp. effect on zero balance	≤ 0.05% R.O./10°C
Terminal input resistance	350 Ohms ±3.5 Ohms
Terminal output resistance	350 Ohms ±5 Ohms
Insulation resistance (Min.)	2000 MOhms at 50V DC
Excitation Voltage	10V(Recommended) /15V(Maximum)
Electrical connection	ø5mmx3m(22AWG x 4Core Shielded)
Protection class	meets IP 67
Safe overload	150% R.C
Ultimate overload	300% R.C

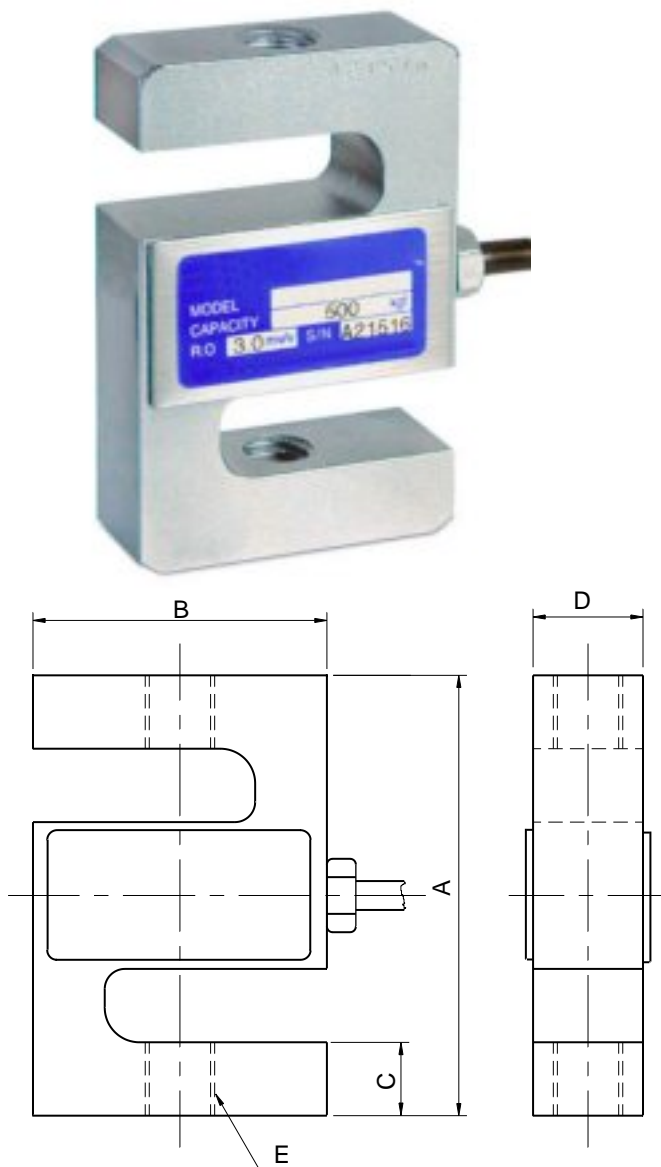

### ORDERING INFORMATION

#### XLS9 - 5T

MODEL	CAPACITY
XLS9	20, 50, 100, 200, 500Kg, 1, 2, 3, 5t
XLS9-S1	50, 100, 200, 400lbs, 1, 2, 4, 6, 10Klbs

### WIRING INFORMATION

RED	: EXC. (+)	WHITE	: EXC. (-)
GREEN	: SIG. (+)	BLUE	: SIG. (-)
BARE	: GND		

### Dimension-mm(inch)

Model	Rated Capacity	A	B	C	D	E	Rod End Ball Joints NO.	Weight(kg)
XLS9	20~100Kg (196.1 ~980.7N)	63.5	50.8	10.4	12.7	M6x1P	n/a	0.40
	200~500Kg (1.96 ~4.90KN)	76.2	50.8	12.7	19.0	M12x1.75P	n/a	0.55
	1t (9.807KN)	76.2	50.8	16.0	25.4	M12x1.75P	n/a	0.73
	2~3t (19.61~29.42KN)	108.0	76.2	20.0	32.0	M20x1.5P	n/a	1.70
	5t (49.03KN)	120.7	88.9	22.1	32.0	M24x2P	n/a	2.10
XLS9-S1	50~200 lbs (196.1 ~980.7N)	(2.50)	(2.00)	(0.41)	(0.50)	1/4-28UNF	n/a	0.40
	400~1000 lbs (1.96 ~4.90KN)	(3.00)	(2.00)	(0.50)	(0.75)	1/2-20UNF	n/a	0.55
	2 Klbs (9.807KN)	(3.00)	(2.00)	(0.50)	(1.00)	1/2-20UNF	n/a	0.73
	4~6 Klbs (19.61~29.42KN)	(4.25)	(3.00)	(0.75)	(1.00)	3/4-16UNF	n/a	1.70
	10 Klbs (49.03KN)	(4.75)	(3.50)	(0.75)	(1.00)	3/4-16UNF	n/a	2.10

Load Cell Central follows a policy of continuous improvement and reserves the right to change specifications without notice. © 2008

Load Cell Central  
216 Main St. / PO Box 91  
Monroeton, PA 18832  
Web: [www.800loadcel.com](http://www.800loadcel.com)

Toll Free: 1-800-562-3235  
Ph: 1-570-265-5015  
Fax: 1-570-265-5148  
Email: [sales@800loadcel.com](mailto:sales@800loadcel.com)